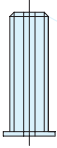

Accessories HDF

Tool group A39

 Type 291-00
Adjusting Screws

Item no.	Clamping dia. min.	Clamping dia. max.
581357	-	4
581358	-	5
576019	-	6
576020	-	8
576021	-	10
576022	12	14
576023	16	18
581359	-	20
581399	25	32

Tool group A39

 Type 291-02
Adjusting screws for heavy design

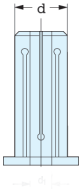

Item no.	Clamping dia.
850155	20
850156	32

Tool group A39

 Type 291-80
Reducer coolant resistant to max. 80 bar.

Item no.	d	Clamping dia.
576201	12	3
576202	12	4
576203	12	5
576204	12	6
576205	12	8
576206	20	3
576207	20	4
576208	20	5
576209	20	6
576210	20	8
576211	20	10
576212	20	12
576213	20	14
576214	20	16
576215	32	6
576216	32	8
576217	32	10
576218	32	12
576219	32	14
576220	32	16
576221	32	18
576222	32	20
576223	32	25

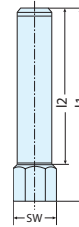
Tool group A39

 Type 291-99
Torque test adaptor

Item no.	d	Length l1	l2	Key-width	Nm
576224	6	53	42	10	10
576225	8	53	42	10	20
576226	10	56	45	10	40
576227	12	62	51	10	50
576228	14	62	51	10	80
576229	16	71	54	17	100
576230	18	71	54	17	125
576231	20	71	55	17	180
576232	25	79	61	17	250
576233	32	87	65	17	400

Tool group A39

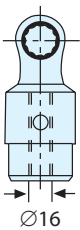
 Type 291-91
Tool key

Item no.	Key-width
576255	10
576256	17

Tool group A39

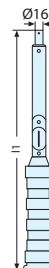
 Type 291-92
Torque wrench

Item no.	Length l1	Nm
576257	400	10-100
576258	400	40-200
576259	400	75-400

Tool group C15

 Type 7023
Hexagon key

Item no.	Length l1	Key-width
202893	100	6
367665	183	4