



For clockwise and anti-clockwise rotation.
For clamping cylindrical shafted tools.

High precision and accurate concentricity.
Secure gripping of the tool through mechanical amplification of the clamping force.
No automatic slackening of the clamping force while machining with either clockwise or anti-clockwise rotation or on spindle stop.

Technical features:

- for quick and easy tool change
- short clamping and tool changing times due to continuously adjustable clamping
- high clamping forces due to angular gears
- low expenditure of clamping energy due to the use of a hexagon wrench
- coolant supply with 50 bar due to the sealed design

Tool group A38
Type 142-20 **Steep taper DIN 2080**
form AD

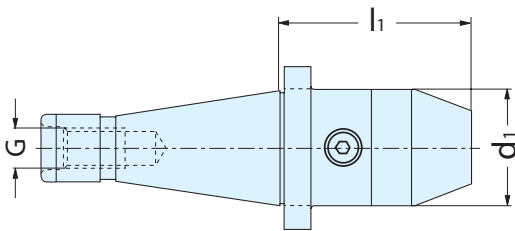

Item no.	Mount SA	Clamping range	d1	l1	G	Weight
893315	SK/SA 40	1-13	50	80	M 16	1500
893316	SK/SA 40	2,5-16	50	85,5	M 16	1700
893317	SK/SA 50	1-13	50	83,5	M 24	3300
893318	SK/SA 50	2,5-16	50	89	M 24	3600

Tool group A38
Type 142-10 **Steep taper DIN 69871**
form AD

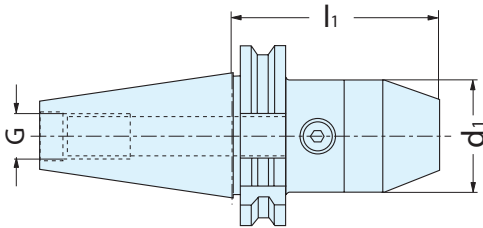

Item no.	Mount SA	Clamping range	d1	l1	G	Weight
893302	30	1-13	50	103	M 12	900
893303	40	1-13	50	87,5	M 16	1500
893304	40	2,5-16	50	93	M 16	1700
893305	50	1-13	50	87,5	M 24	3300
893306	50	2,5-16	50	93	M 24	3600

Tool group A38
Type 142-12 **Steep taper DIN 69871**
form AD/B - with coolant feed

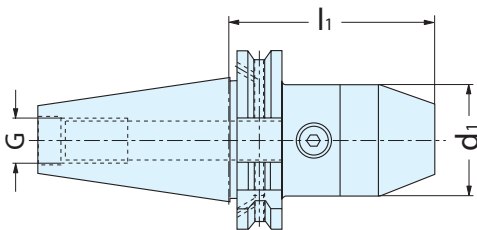

Item no.	Mount SA	Clamping range	d1	l1	G	Weight
893307	40	1-13	50	88,5	M 16	1500
893308	40	2,5-16	50	93	M 16	1700
893309	50	1-13	50	103	M 24	3300
893310	50	2,5-16	50	108,5	M 24	3600

Tool group A38
Type 142-30 **MAS BT 403**

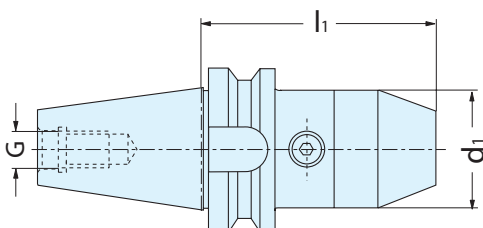

Item no.	Mount MAS BT	Clamping range	d1	l1	G	Weight
893311	40	1-13	50	95,5	M 16	1500
893312	40	2,5-16	50	101	M 16	1700
893313	50	1-13	50	106,5	M 24	3300
893314	50	2,5-16	50	112	M 24	3600

KBF

Tool group A38
 Type 142-50 VDI 3425 DIN 69880
 with coolant feed

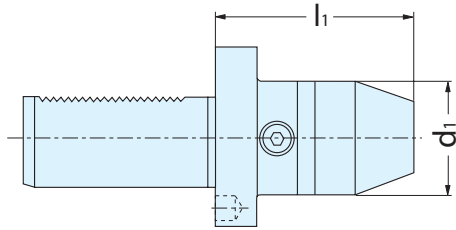

Item no.	Mount VDI	Clamping range	d1	l1	Weight
893319	40	1-13	50	75	1300
893320	40	2,5-16	50	92	1500

Tool group C15
 Type 7023
 Hexagon key



Item no.	Length l1	Key-width
202893	100	6