

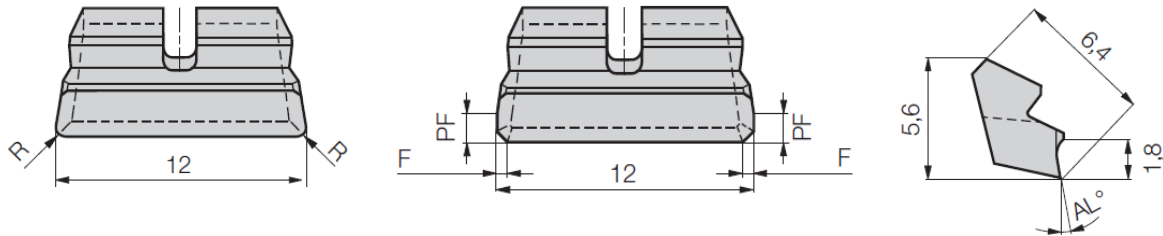

Insert W 6120-..... N Carbide / carbide coated / PCD



with radius (R) **or** with chamfer (F) and wiper geometry (PF)

Carbide						Part nr.	Part nr.	Part nr.	Part nr.
						20305	20499	20501	20503
						uncoated	coated	coated	coated
Code	Drawing nr.	R	AL°	F	PF	K10	G12	G16	G26
61,200	W6120-0318 1645N		16	0.3x45°	1	●	○	○	○
61,201	W6120-0418 1620N	0.4	16			●	○	○	○
61,202	W6120-0318 1045N		10	0.3x45°	1	○	●	●	●
61,203	W6120-0418 1000N	0.4	10			○	●	●	●
PCD						Part nr.	Part nr.		
						20309	20310		
Code	Drawing nr.	R	AL°	F	PF	PCD10	PCD30		
61,200	W6120-0318 1045N		10	0.3x45°	1	●	○		
61,201	W6120-0318 0045N		0	0.3x45°	1	●	○		
61,202	W6120-0418 0000N	0.4	0			●	○		
						Part nr.			
						20390			
Code	Drawing nr.	R	AL°	F	PF	PCD10			
61,201	W6120-0118 6245R		6	0.1x45°	1.8	●			

● ex stock ○ in short time available

We reserve the right to make technical changes.