



**Toolholders with HSK-tapers shank DIN 69893-1**

**Broaching toolholders for internal profiles**

Delivery without broaching cutter



**HSK - A**

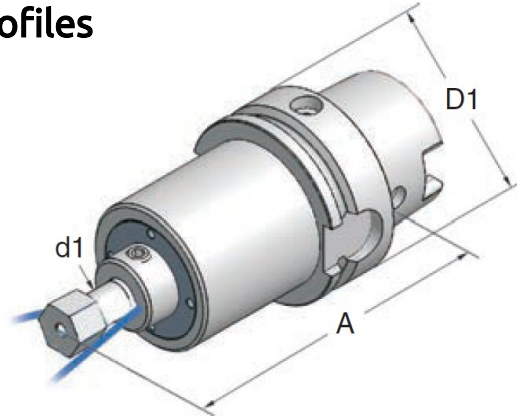

**HSK - A 40**

	<b>Art.-Nr.</b>	<b>Type</b>	<b>D1</b>	<b>A</b>	<b>d1</b>
	40.11.08.5000	HSK-A40x08x 95	40	95	8
	<b>HSK - A 63</b>				
	50.11.12.5000	HSK-A63x12x115	63	115	12

**HSK - C**

**HSK - C 50**

	<b>Art.-Nr.</b>	<b>Type</b>	<b>D1</b>	<b>A</b>	<b>d1</b>
	50.14.12.5000	HSK-C50x12x100	50	100	12

**HSK - E**

**HSK - E 40**

	<b>Art.-Nr.</b>	<b>Type</b>	<b>D1</b>	<b>A</b>	<b>d1</b>
	40.12.08.5000	HSK-E40x08x 95	40	95	8

We reserve the right to make technical changes.

## Toolholders with HSK-tapers shank DIN 69893-1

### Reduction

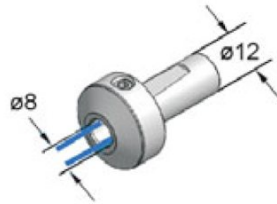

Art.-Nr.	Type
1208.5000	Reduction $\varnothing 12/\varnothing 8$

### Control arbor

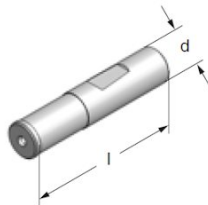

Art.-Nr.	d	l
08.5000	8	28
12.5000	12	55

### Hexagon-broaching cutters

#### TIN coated

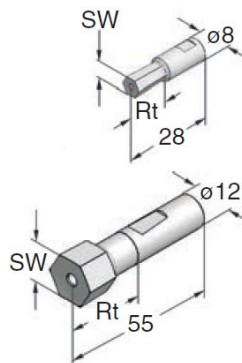

Art.-Nr.	SW	$\varnothing$	Depth	Art.-Nr.	SW	$\varnothing$	Depth
08.015	1.5	8	3	12.070	7	12	13
08.020	2	8	4	12.080	8	12	15
08.025	2.5	8	4	12.090	9	12	16
08.030	3	8	5	12.100	10	12	19
08.040	4	8	7	12.110	11	12	19
08.050	5	8	9	12.120	12	12	19
08.060	6	8	11	12.130	13	12	19
08.070	7	8	11	12.140	14	12	24
08.080	8	8	11	12.150	15	12	24
08.100	10	8	14	12.160	16	12	24
12.040	4	12	7	12.170	17	12	24
12.050	5	12	9	12.190	19	12	24
12.060	6	12	11	12.220	22	12	24

We reserve the right to make technical changes.

## Hexagon-broaching cutters INCH

TIN coated

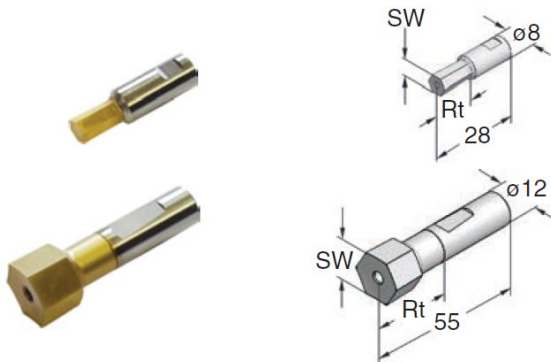

Art.-Nr.	SWINCH	ø	Depth	Art.-Nr.	SWINCH	ø	Depth
08.3/32	3/32"	8	4	08.5/16	5/16"	8	11
08.7/64	7/64"	8	4	08.3/8	3/8"	8	11
08.1/8	1/8"	8	5	12.1/4	1/4"	12	11
08.3/16	3/16"	8	9	12.3/8	3/8"	12	19
08.7/32	7/32"	8	9	12.7/16	7/16"	12	19
08.1/4	1/4"	8	11	12.1/2	1/2"	12	19

## Broaching cutters TORX EN ISO 10664

TIN coated

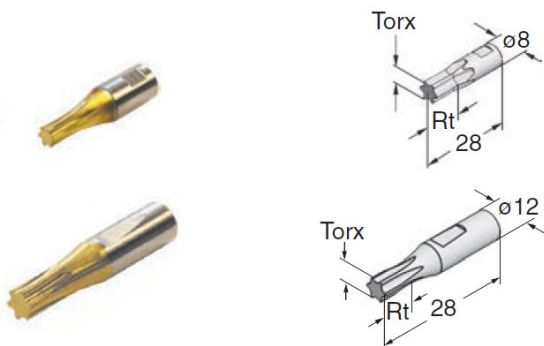

Art.-Nr.	TORX	ø	Depth	Art.-Nr.	TORX	ø	Depth
08.T05	5	8	3	08.T25	25	8	4
08.T06	6	8	3	08.T27	27	8	4
08.T07	7	8	3	08.T30	30	8	4
08.T08	8	8	3	08.T40	40	8	5
08.T09	9	8	3	08.T45	45	8	5
08.T10	10	8	3	12.T50	50	12	7
08.T15	15	8	3	12.T55	55	12	10
08.T20	20	8	4				

We reserve the right to make technical changes.