



## ISO Taper-toolholders MAS BT15

### Broaching toolholder

Delivery without broaching cutter



**MAS BT 15**

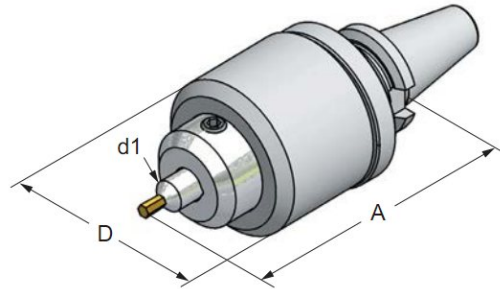

### MAS BT 15

Art.-Nr.	Type	d1	D	A
15.05.08.5000	BT15x08x78	8	40	78

### Shrinking chucks without coolant channels

Taper angle AT3, Concentricity from the taper to the holding part < 0.005

Base-body balanced, G 2.5 - 30,000 U/min. or U < 1 gmm



**MAS BT 15**

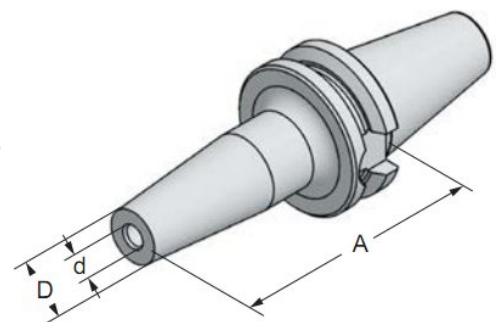

### MAS BT 15

Art.-Nr.	Type	A	d	D
15.05.03.31	BT15x03Sx50-AD	50	3	10
15.05.04.31	BT15x04Sx50-AD	50	4	10
15.05.05.31	BT15x05Sx50-AD	50	5	14

### MAS BT 15

Art.-Nr.	Type	A	d	D
15.05.06.31	BT15x06Sx50-AD	50	6	14
15.05.08.31	BT15x08Sx50-AD	50	8	14
15.05.10.31	BT15x10Sx40-AD	40	10	16

We reserve the right to make technical changes.

# ISO Taper-toolholders MAS BT15

## Collet chucks for collets DIN 6499 (ER/ESX)

Taper angle AT3, Concentricity from the taper to the holding part < 0.005

Base-body balanced, G 2.5 - 30,000 U/min. or U < 1 gmm



**MAS BT 15**

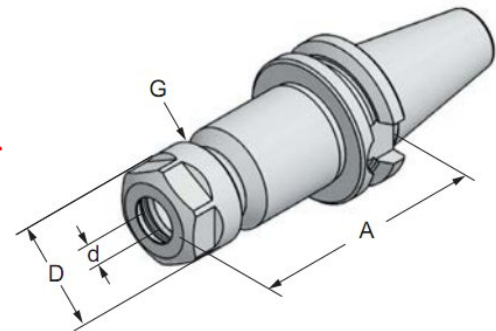

### MAS BT 15

Art.-Nr.	Type	A	d	D	G
15.05.07.2	BT15xER11x50-AD	50	1-7	19	M14x0.75

### MAS BT 15

Art.-Nr.	Type	A	d	D	G
15.05.10.2	BT15xER16x40-AD	40	1-10	28	M22x1.5
15.05.10.22	BT15xER16x75-AD	75	1-10	28	M22x1.5

We reserve the right to make technical changes.